

FIG1

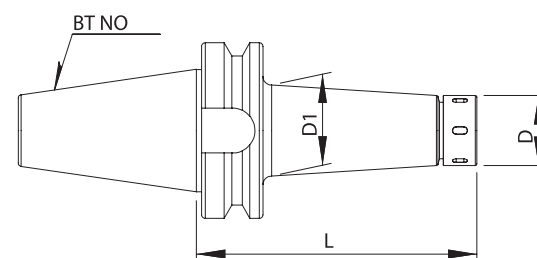

FIG2

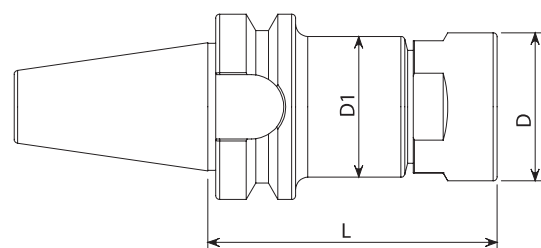

FIG3

SPECIFICATIONS 規格表

ORDER NO.	FIG	RANGE	ØD	ØD1	L	NUT	WRENCH
訂購編號		夾持範圍				螺帽	板手
BT30-PSK10-045	1	Ø 2 - 10	30	30	45	PSK10	PSK10
BT30-PSK10-060					60		
BT30-PSK10-090					90		
BT30-PSK10-130					130		
BT30-PSK13-060	3	Ø 3 - 13	37	35	60	PSK13	PSK13
BT30-PSK13-075					75		
BT30-PSK13-090					90		
BT30-PSK13-130					130		
BT30-PSK16-060	1	Ø 3 - 16	42	40	60	PSK16	PSK16
BT30-PSK16-090					90		
BT30-PSK16-130					130		
BT30-PSK20-060	1	Ø 3 - 20	51	50	60	PSK20	PSK20
BT30-PSK20-090					90		
BT30-PSK25-090	1	Ø 4 - 25	56	55	90	PSK25	PSK25
BT40-PSK10-060	1	Ø 2 - 10	30	30	60	PSK10	PSK10
BT40-PSK10-090					90		
BT40-PSK10-120					120		
BT40-PSK10-150	2			34	150		
BT40-PSK10-165				36	165		
BT40-PSK10-200					200		
BT40-PSK13-060	3	Ø 3 - 13	37	35	60	PSK13	PSK13
BT40-PSK13-090					90		
BT40-PSK13-120					120		
BT40-PSK13-150	2			40	150		
BT40-PSK13-165				42	165		
BT40-PSK13-200					200		
BT40-PSK16-060	1	Ø 3 - 16	42	40	60	PSK16	PSK16
BT40-PSK16-090					90		
BT40-PSK16-120					120		
BT40-PSK16-150	2			46	150		
BT40-PSK16-165				48	165		
BT40-PSK16-200				50	200		
BT40-PSK20-060	1	Ø 3 - 20	51	50	60	PSK20	PSK20
BT40-PSK20-090					90		
BT40-PSK20-120					120		
BT40-PSK20-150	2			55	150		
BT40-PSK20-200					200		
BT40-PSK25-080	1	Ø 4 - 25	56	55	80	PSK25	PSK25
BT40-PSK25-120					120		
BT40-PSK25-150					150		
BT40-PSK25-200					200		

應用於： ▼一般銑削/鑽孔加工
▼高精度銑削/銑孔加工
偏擺精度：≤0.005mm.
動平衡等級：≤G2.5/30.000RPM(BT30)
≤G2.5/25.000RPM(BT40)

Application： ▼General milling/drilling.
▼High precision milling/reaming.
Run-out Precision：≤0.005mm.
Balanced Grade：≤G2.5/30.000RPM(BT30)
≤G2.5/25.000RPM(BT40)

SPECIFICATIONS 規格表

ORDER NO. 訂購編號	FIG	RANGE	ØD	ØD1	L	NUT	WRENCH		
		夾持範圍				螺帽	板手		
BT50-PSK10-105	1	Ø 2 - 10	30	30	105	PSK10	PSK10		
BT50-PSK10-135					135				
BT50-PSK10-150	2			34	150				
BT50-PSK10-165					165				
BT50-PSK10-200				36	200				
BT50-PSK13-105	3	Ø 3 - 13	37	35	105	PSK13	PSK13		
BT50-PSK13-135					135				
BT50-PSK13-150	2			40	150				
BT50-PSK13-165					165				
BT50-PSK13-200				42	200				
BT50-PSK16-065	1	Ø 3 - 16	42	40	65	PSK16	PSK16		
BT50-PSK16-105					105				
BT50-PSK16-135					135				
BT50-PSK16-150					150				
BT50-PSK16-165	2			46	165			PSK16	PSK16
BT50-PSK16-200					200				
BT50-PSK16-250				48	250				
BT50-PSK16-300				52	300				
BT50-PSK20-105	1	Ø 3 - 20	51	50	105	PSK20	PSK20		
BT50-PSK20-135					135				
BT50-PSK20-150					150				
BT50-PSK20-165	2			55	165			PSK20	PSK20
BT50-PSK20-200					200				
BT50-PSK20-250				58	250				
BT50-PSK20-300				60	300				
BT50-PSK25-105	1	Ø 4 - 25	56	55	105	PSK25	PSK25		
BT50-PSK25-135					135				
BT50-PSK25-150					150				
BT50-PSK25-165	2			60	165			PSK25	PSK25
BT50-PSK25-200					200				
BT50-PSK25-250				62	250				
BT50-PSK25-300				64	300				

應用於： ▼一般銑削/鑽孔加工
▼高精度銑削/鉋孔加工
偏擺精度：≤0.005mm.
動平衡等級：≤G2.5/30.000RPM(BT30)
≤G2.5/25.000RPM(BT40)

Application： ▼General milling/drilling.
▼High precision milling/reaming.
Run-out Precision：≤0.005mm.
Balanced Grade：≤G2.5/30.000RPM(BT30)
≤G2.5/25.000RPM(BT40)