

FIG1

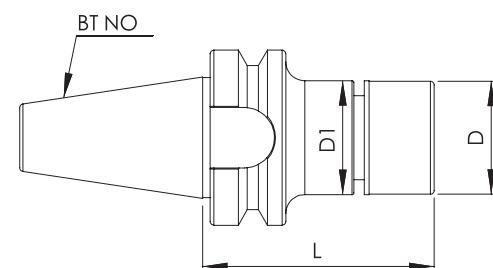
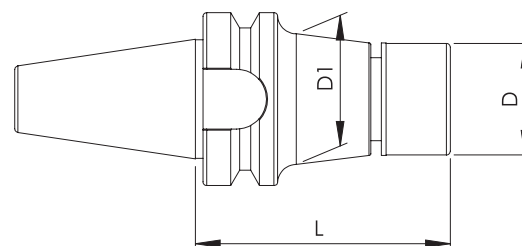

FIG2



SPECIFICATIONS 規格表

ORDER NO. 訂購編號	FIG	RANGE	ØD	ØD1	L	NUT	WRENCH
		夾持範圍				螺帽	板手
BT30-PSK10-045G	1	Ø 2 - 10	30	30	45	PSK10G	PSK10G
BT30-PSK10-060G					60		
BT30-PSK10-090G					90		
BT30-PSK10-130G					130		
BT30-PSK13-060G	1	Ø 3 - 13	35	35	60	PSK13G	PSK13G
BT30-PSK13-075G					75		
BT30-PSK13-090G					90		
BT30-PSK13-130G					130		
BT30-PSK16-060G	1	Ø 3 - 16	40	40	60	PSK16G	PSK16G
BT30-PSK16-090G					90		
BT30-PSK16-130G					130		
BT30-PSK20-060G	1	Ø 3 - 20	50	50	60	PSK20G	PSK20G
BT30-PSK20-090G					90		
BT30-PSK25-090G			Ø 4 - 25	55	55	90	PSK25G
BT40-PSK10-060G	1	Ø 2 - 10	30	30	60	PSK10G	PSK10G
BT40-PSK10-090G					90		
BT40-PSK10-120G					120		
BT40-PSK10-150G	2			34	150		
BT40-PSK10-165G					165		
BT40-PSK10-200G					200		
BT40-PSK13-060G	1	Ø 3 - 13	35	35	60	PSK13G	PSK13G
BT40-PSK13-090G					90		
BT40-PSK13-120G					120		
BT40-PSK13-150G	2			40	150		
BT40-PSK13-165G					165		
BT40-PSK13-200G					200		
BT40-PSK16-060G	1	Ø 3 - 16	40	40	60	PSK16G	PSK16G
BT40-PSK16-090G					90		
BT40-PSK16-120G					120		
BT40-PSK16-150G	2			46	150		
BT40-PSK16-165G					165		
BT40-PSK16-200G					200		
BT40-PSK20-060G	1	Ø 3 - 20	50	50	60	PSK20G	PSK20G
BT40-PSK20-090G					90		
BT40-PSK20-120G					120		
BT40-PSK20-150G	2			55	150		
BT40-PSK20-200G					200		
BT40-PSK25-080G	1			Ø 4 - 25	55		
BT40-PSK25-120G		120					
BT40-PSK25-150G		150					
BT40-PSK25-200G		200					

應用於：▼一般銑削/鑽孔加工
▼高精度銑削/鉋孔加工
偏擺精度：≤0.005mm.
使用高速全圓螺帽
動平衡等級：≤G2.5/30.000RPM(BT30)
≤G2.5/25.000RPM(BT40)

Application：▼General milling/drilling.
▼High precision milling/reaming.
Run-out Precision：≤0.005mm.
Use high speed round nut.
Balanced Grade：≤G2.5/30.000RPM(BT30)
≤G2.5/25.000RPM(BT40)

SPECIFICATIONS 規格表

ORDER NO.	FIG	RANGE	ØD	ØD1	L	NUT	WRENCH		
訂購編號		夾持範圍				螺帽	板手		
BT50-PSK10-105G	1	Ø 2 - 10	30	30	105	PSK10G	PSK10G		
BT50-PSK10-135G					135				
BT50-PSK10-150G	2			34	150			PSK10G	PSK10G
BT50-PSK10-165G					165				
BT50-PSK10-200G				36	200				
BT50-PSK13-105G	1	Ø 3 - 13	35	35	105	PSK13G	PSK13G		
BT50-PSK13-135G					135				
BT50-PSK13-150G	2			40	150			PSK13G	PSK13G
BT50-PSK13-165G					165				
BT50-PSK13-200G				42	200				
BT50-PSK16-065G	1	Ø 3 - 16	40	40	65	PSK16G	PSK16G		
BT50-PSK16-105G					105				
BT50-PSK16-135G					135				
BT50-PSK16-150G					150				
BT50-PSK16-165G	2			46	165			PSK16G	PSK16G
BT50-PSK16-200G					200				
BT50-PSK16-250G				48	250				
BT50-PSK16-300G				52	300				
BT50-PSK20-105G	1	Ø 3 - 20	50	50	105	PSK20G	PSK20G		
BT50-PSK20-135G					135				
BT50-PSK20-150G					150				
BT50-PSK20-165G	2			55	165			PSK20G	PSK20G
BT50-PSK20-200G					200				
BT50-PSK20-250G				58	250				
BT50-PSK20-300G				60	300				
BT50-PSK25-105G	1	Ø 4 - 25	55	55	105	PSK25G	PSK25G		
BT50-PSK25-135G					135				
BT50-PSK25-150G					150				
BT50-PSK25-165G	2			60	165			PSK25G	PSK25G
BT50-PSK25-200G					200				
BT50-PSK25-250G				62	250				
BT50-PSK25-300G				64	300				

應用於： ▼一般銑削/鑽孔加工
▼高精度銑削/鉸孔加工
偏擺精度：≤0.005mm.
使用高速全圓螺帽
動平衡等級：≤G2.5/30.000RPM(BT30)
≤G2.5/25.000RPM(BT40)

Application： ▼General milling/drilling.
▼High precision milling/reaming.
Run-out Precision：≤0.005mm.
Use high speed round nut.
Balanced Grade：≤G2.5/30.000RPM(BT30)
≤G2.5/25.000RPM(BT40)