

ER-S

彈性筒夾刀桿 高速全圓螺帽
Collet Chucks High Speed Fully Round Nut

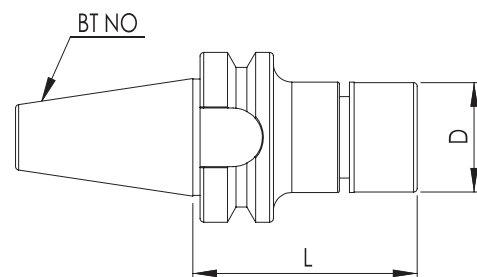

ER-S High Speed Fully Round Nut 高速全圓螺帽

ORDER NO. 訂購編號	ØD	L	M
ER16S	30	19.5	M22 x 1.5P
ER20S	35	22.0	M28 x 1.5P
ER25S	40	24.0	M32 x 1.5P
ER32S	50	26.0	M40 x 1.5P

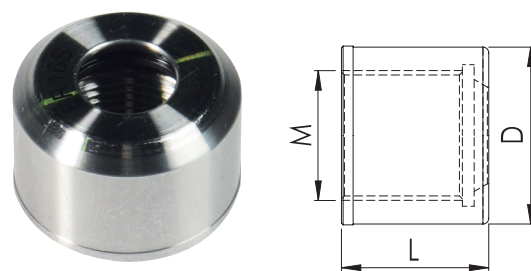

ER-S Wrench 板手

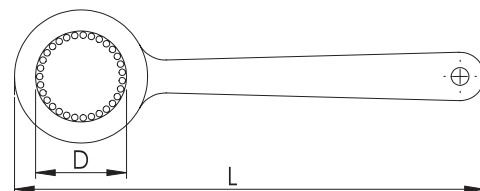

ORDER NO. 訂購編號	ØD	L
ER16S	30	145
ER20S	35	155
ER25S	40	175
ER32S	50	195



SPECIFICATIONS 規格表

ORDER NO. 訂購編號	RANGE 夾持範圍	ØD	L	NUT 螺帽	WRENCH 板手
BT30-ER16-060S	Ø 1 - 10	30	60	ER16S	ER16S
BT30-ER16-100S			100		
BT30-ER20-060S	Ø 1 - 13	35	60	ER20S	ER20S
BT30-ER20-100S			100		
BT30-ER25-060S	Ø 2 - 16	40	60	ER25S	ER25S
BT30-ER25-100S			100		
BT30-ER32-060S	Ø 3 - 20	50	60	ER32S	ER32S
BT30-ER32-100S			100		

BT40-ER16-070S	Ø 1 - 10	30	70	ER16S	ER16S
BT40-ER16-100S			100		
BT40-ER20-070S	Ø 1 - 13	35	70	ER20S	ER20S
BT40-ER20-100S			100		
BT40-ER25-070S	Ø 2 - 16	40	70	ER25S	ER25S
BT40-ER25-100S			100		
BT40-ER32-070S	Ø 3 - 20	50	70	ER32S	ER32S
BT40-ER32-100S			100		

應用於： ▼一般銑削 / 鑽孔加工
▼高精度銑削 / 鉸孔加工
使用高速全圓螺帽

Application : ▼General milling / drilling.
▼High precision milling / reaming.
Use high speed round nut.

