

FEATURE 特性介紹

1. 貼合面採齒型咬合設計，重切削穩定性極佳，確保不偏擺。
2. 刻度調整採雙向滑動，鎖定後減少間隙誤差值，校刀不費力。
3. 革命性的升級，採用高級合金鋼，經真空熱處理，徹底強化內、外韌性。
4. 加工效能的提升，是本產品多項專利以及開發的目標。

1. Gear-interference design between the insert holders and boring block for stable boring and machining even under heavy duty course.
2. Two-side-slide design for the adjustment of both holders and no clearance and for more precision cutting tool setting.
3. High quality alloy steel body with vacuum-heat treatment for rigid construction.
4. Construction and functions patented.

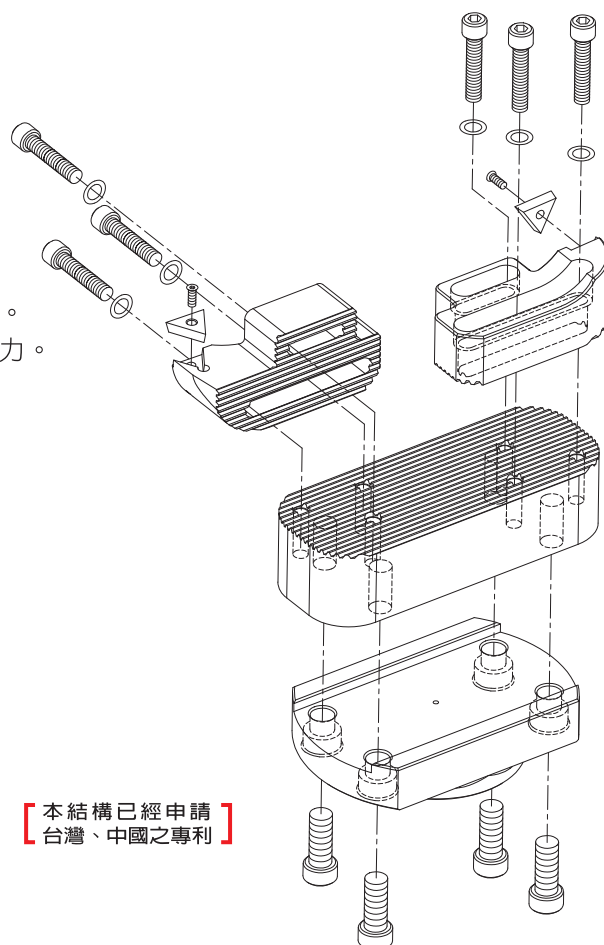

【本結構已經申請
台灣、中國之專利】



BST350-400



BST200-250



BST160-204

SPECIFICATIONS 規格表

TYPE 型號	Fig.	ØA Range 搪孔範圍		ØD	L	Shank 刀桿型號	Insert 刀片規格	Weight 搪頭重量
		min	max					
BST120-164-03C	1	Ø 120	Ø 164	95	95	BST	CCMT120408	3.4KG
BST120-164-03T							TCMT16T304	
BST160-204-03C	1	Ø 160	Ø 204	128	95	BST	CCMT120408	4.8KG
BST160-204-03T							TCMT16T304	
BST200-250-03C	2	Ø 200	Ø 250	150	115	BST	CCMT120408	7.9KG
BST200-250-03T							TCMT16T304	
BST250-300-03C	2	Ø 250	Ø 300	190	115	BST	CCMT120408	9.9KG
BST250-300-03T							TCMT16T304	
BST300-350-03C	2	Ø 300	Ø 350	240	115	BST	CCMT120408	11.9KG
BST300-350-03T							TCMT16T304	
BST350-400-03C	2	Ø 350	Ø 400	290	115	BST	CCMT120408	12.5KG
BST350-400-03T							TCMT16T304	
BST400-450-03C	2	Ø 400	Ø 450	290	115	BST	CCMT120408	12.8KG
BST400-450-03T							TCMT16T304	
BST450-500-03C	2	Ø 450	Ø 500	290	115	BST	CCMT120408	14.1KG
BST450-500-03T							TCMT16T304	

INSERT	SCREW	WRENCH	INSERT	SCREW	WRENCH
CC..1204..	S5002-6	T20	TC..16T3..	S4001-3	T15

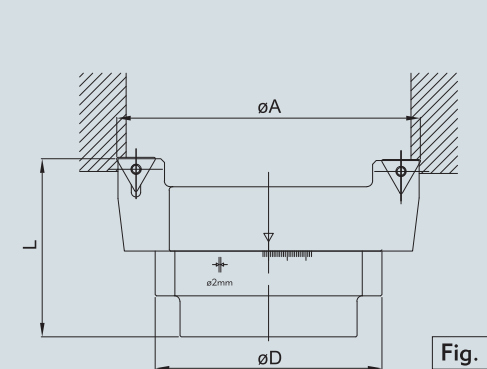

Fig. 1

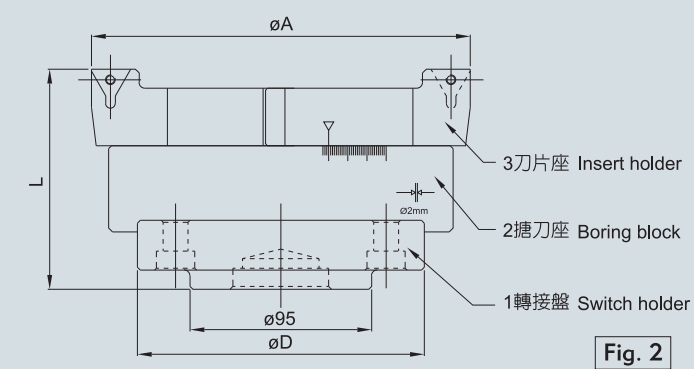

Fig. 2